

## Super Thin SVGA Cable, HD15 Male / Female, 50.0 ft

### Features for this product

- Connection of a signal generating device (CPU) and a display device (Monitor)
- Small cable and backshell design addresses space sensitive applications
- 3 ultra thin 75 Ohm coaxial lines optimize video signal quality
- User defined hardware results in maximum mounting flexibility
- Available from stock in 5 standard lengths from 5 to 50 ft



Big performance in a small package is what this series is all about. Utilizing a revolutionary cable which is made with 3 ultra thin coaxial lines and still measures less than .23" in diameter! In addition to the small cable size these cables feature an innovative shallow backshell design producing a cable assembly ideally suited to any space sensitive application. Another unique feature is user-defined mounting hardware. Each cable end is capable of being connected with either male jack screws or hex standoffs with the supplied hardware! This feature enables either the male or female end to be panel mounted. Most lengths available from stock for immediate delivery.

### Details for this Monitor, Video product

L-com Item #	CTL3VGAMF-50T
Manufacturer	L-com
UPC #	822335017214
RoHS Status	<a href="#">Partially RoHS Compliant Stock</a> 
# Coax	3

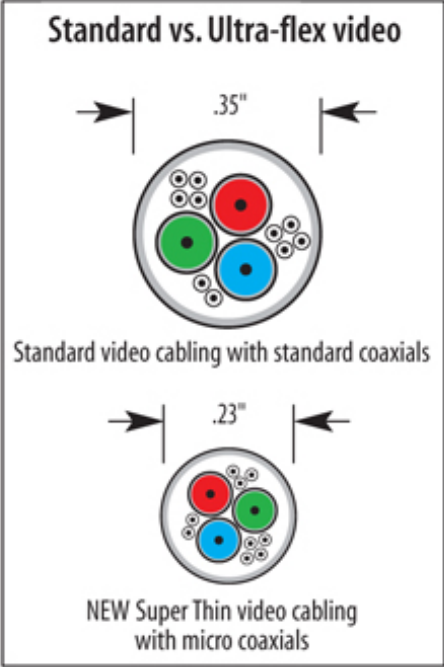
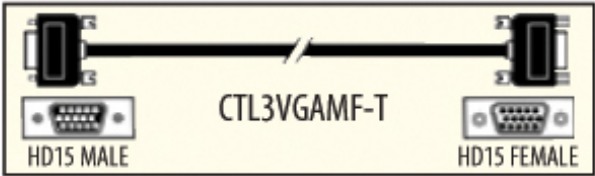

**Super Thin SVGA is Ideal for Tight Fitting Spaces**

The Super Thin SVGA series offers comparable performance of standard size SVGA assemblies in a much more compact size. Not only is the cable diameter greatly reduced but the depth of the HD15 backshell is also much more shallow than the backshells found on most SVGA assemblies. This results in a SVGA assembly that can be used in tight confines where a standard size SVGA assembly would be difficult if not impossible to use.

An additional feature of this series is reversible hardware allowing either panel mount using standoffs or traditional thumbscrews. The combined results of these features is a product series that is both compact and versatile. These features can be utilized to solve many difficult installation problems without sacrificing performance.

The Super Thin small profile construction is also utilized on our SVGA with disconnect series and our low profile KVM cable.

**Note:** All dimensions are for reference only.

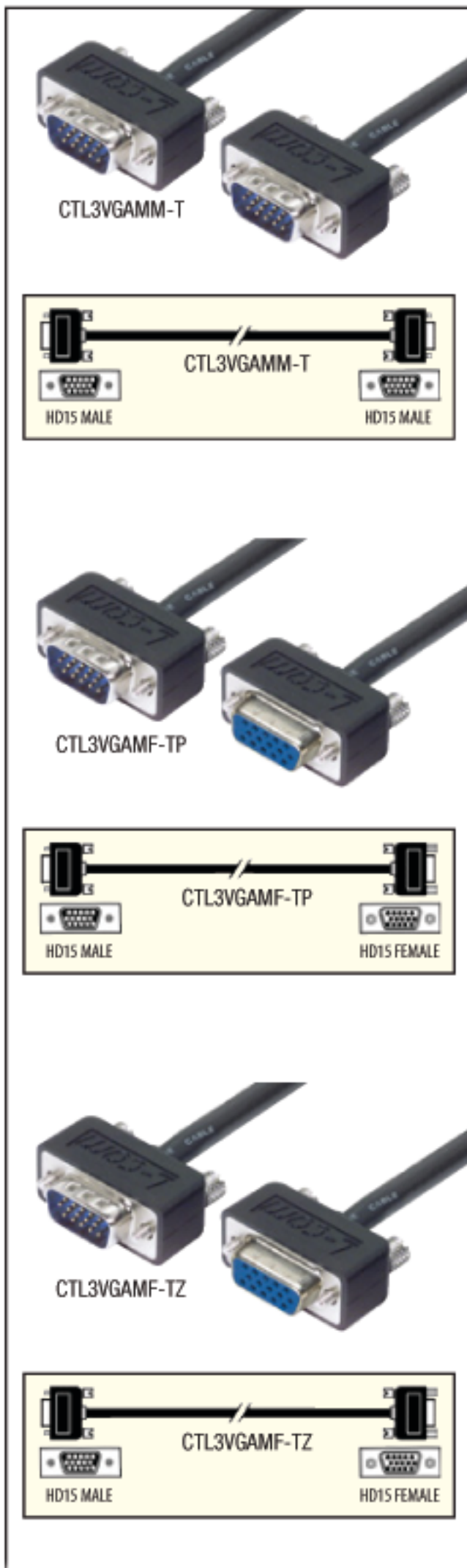
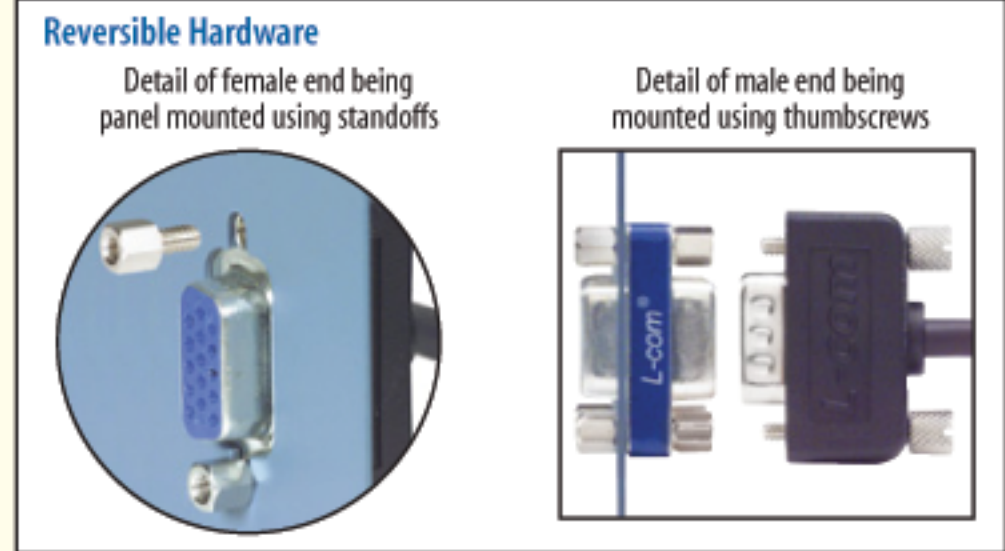
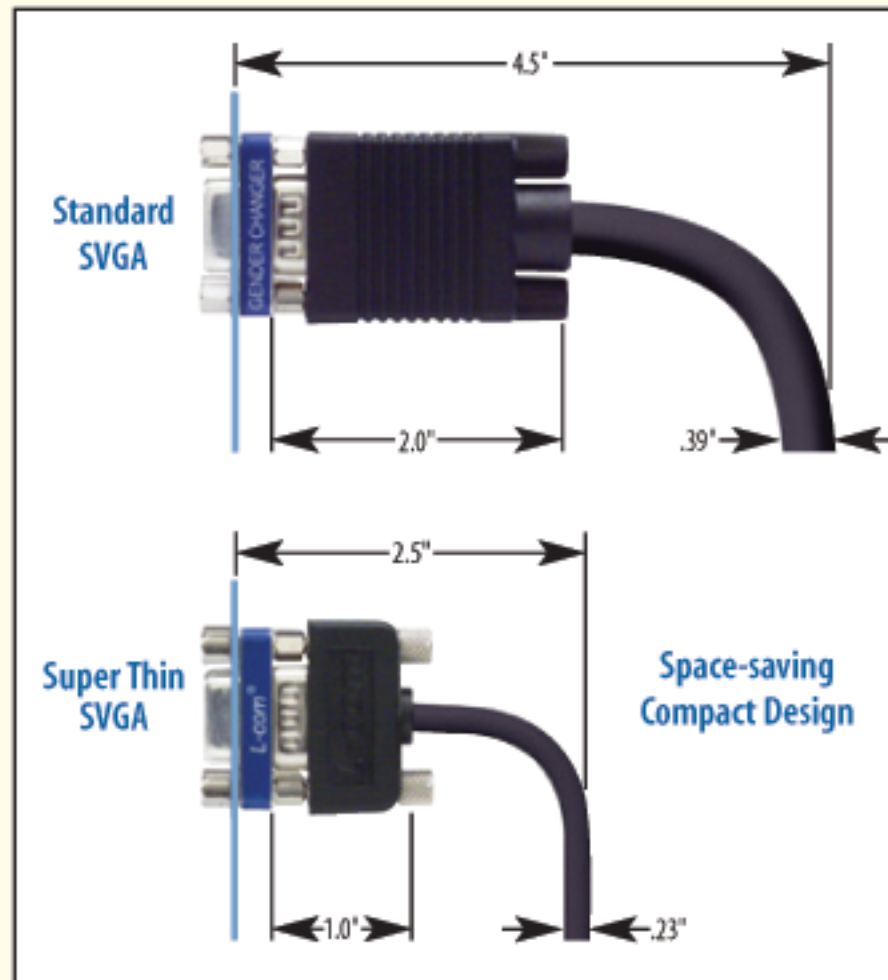

Item #	Description	#Coax
<b>✓ Super Thin SVGA Cables with 3 Mini Coaxial Lines - HD15M to HD15M or HD15F</b>		
Utilize a revolutionary cable made with 3 ultra thin coaxial lines and still measures less than .23" in diameter! Another unique feature is user defined mounting hardware. Each cable end is capable of being connected with either male jack screws or hex standoffs with the supplied hardware! Color: Black.		
<a href="#">CTL3VGAMM-5T</a>	Super Thin SVGA Cable, HD15 Male / Male, 5.0 ft	3
<a href="#">CTL3VGAMM-10T</a>	Super Thin SVGA Cable, HD15 Male / Male, 10.0 ft	3
<a href="#">CTL3VGAMM-15T</a>	Super Thin SVGA Cable, HD15 Male / Male, 15.0 ft	3
<a href="#">CTL3VGAMM-25T</a>	Super Thin SVGA Cable, HD15 Male / Male, 25.0 ft	3
<a href="#">CTL3VGAMM-50T</a>	Super Thin SVGA Cable, HD15 Male / Male, 50.0 ft	3
<a href="#">CTL3VGAMF-5T</a>	Super Thin SVGA Cable, HD15 Male / Female, 5.0 ft	3
<a href="#">CTL3VGAMF-10T</a>	Super Thin SVGA Cable, HD15 Male / Female, 10.0 ft	3
<a href="#">CTL3VGAMF-15T</a>	Super Thin SVGA Cable, HD15 Male / Female, 15.0 ft	3
<a href="#">CTL3VGAMF-25T</a>	Super Thin SVGA Cable, HD15 Male / Female, 25.0 ft	3
<a href="#">CTL3VGAMF-50T</a>	Super Thin SVGA Cable, HD15 Male / Female, 50.0 ft	3
<b>✓ Plenum Jacket Super Thin SVGA Cables - HD15M to HD15M or HD15F</b>		
This series is identical to our Super Thin SVGA cables with one important exception, the cable outer jacket and HD15 connector backshell overmold are made from CMP grade plenum material. Color: Black.		
<a href="#">CTL3VGAMM-5TP</a>	Super Thin Plenum SVGA Cable, HD15 Male / Male, 5.0 ft	3
<a href="#">CTL3VGAMM-10TP</a>	Super Thin Plenum SVGA Cable, HD15 Male / Male, 10.0 ft	3
<a href="#">CTL3VGAMM-15TP</a>	Super Thin Plenum SVGA Cable, HD15 Male / Male, 15.0 ft	3
<a href="#">CTL3VGAMM-25TP</a>	Super Thin Plenum SVGA Cable, HD15 Male / Male, 25.0 ft	3
<a href="#">CTL3VGAMM-50TP</a>	Super Thin Plenum SVGA Cable, HD15 Male / Male, 50.0 ft	3
<a href="#">CTL3VGAMF-5TP</a>	Super Thin Plenum SVGA Cable, HD15 Male / Female, 5.0 ft	3
<a href="#">CTL3VGAMF-10TP</a>	Super Thin Plenum SVGA Cable, HD15 Male / Female, 10.0 ft	3
<a href="#">CTL3VGAMF-15TP</a>	Super Thin Plenum SVGA Cable, HD15 Male / Female, 15.0 ft	3
<a href="#">CTL3VGAMF-25TP</a>	Super Thin Plenum SVGA Cable, HD15 Male / Female, 25.0 ft	3
<a href="#">CTL3VGAMF-50TP</a>	Super Thin Plenum SVGA Cable, HD15 Male / Female, 50.0 ft	3
<b>✓ LSZH Jacket Super Thin SVGA Cables – HD15M to HD15M or HD15F Cable Assembly</b>		
This series of SVGA cables features both our small diameter Super Thin cable and our LSZH jacket for applications where low smoke is critical. An additional feature of this series is our reversible hardware allowing both panel mount using standoffs or traditional thumbscrews. High quality video signal transmission is assured as a result of the three 75 Ohm coaxial lines used in these premium SVGA assemblies. The low profile configuration of our fully molded HD15 backshell makes these assemblies ideal for tight fit installations. Available in 5 standard lengths from 5 to 50 feet.		
<a href="#">CTL3VGAMM-5TZ</a>	Super Thin LSZH SVGA Cable, HD15 Male / Male, 5.0 ft	3
<a href="#">CTL3VGAMM-10TZ</a>	Super Thin LSZH SVGA Cable, HD15 Male / Male, 10.0 ft	3
<a href="#">CTL3VGAMM-15TZ</a>	Super Thin LSZH SVGA Cable, HD15 Male / Male, 15.0 ft	3
<a href="#">CTL3VGAMM-25TZ</a>	Super Thin LSZH SVGA Cable, HD15 Male / Male, 25.0 ft	3
<a href="#">CTL3VGAMM-50TZ</a>	Super Thin LSZH SVGA Cable, HD15 Male / Male, 50.0 ft	3
<a href="#">CTL3VGAMF-5TZ</a>	Super Thin LSZH SVGA Cable, HD15 Male / Female, 5.0 ft	3
<a href="#">CTL3VGAMF-10TZ</a>	Super Thin LSZH SVGA Cable, HD15 Male / Female, 10.0 ft	3
<a href="#">CTL3VGAMF-15TZ</a>	Super Thin LSZH SVGA Cable, HD15 Male / Female, 15.0 ft	3
<a href="#">CTL3VGAMF-25TZ</a>	Super Thin LSZH SVGA Cable, HD15 Male / Female, 25.0 ft	3
<a href="#">CTL3VGAMF-50TZ</a>	Super Thin LSZH SVGA Cable, HD15 Male / Female, 50.0 ft	3